

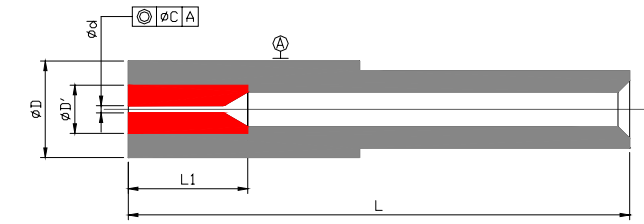

● **Module Ferrule**

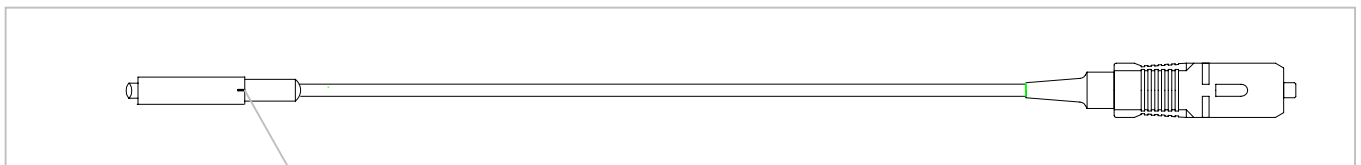

● **Module Pigtail**

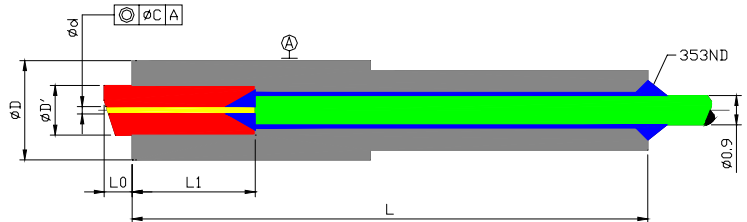
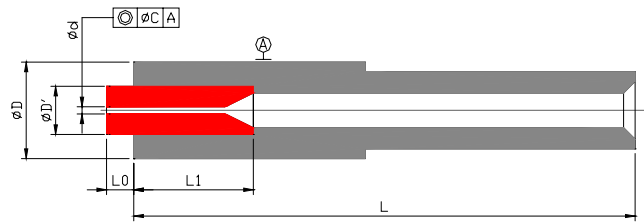

Laser Mark Indicating Orientation of 8° Angle of Fiber Stub

● **Technical Specification**

Mode	Single Mode	Multi Mode
Metal Holder Length L	Max. 14.0mm for SUS304, Max. 15.0mm for SUS303	
Stub Length L1	3.0mm (Reference)	
Stub Protruding Length L0	0.5±0.1	
OD (φD)	Φ1.8 ~ 2.5	
Tolerance	± 0.001~	± 0.002 ~
Concentricity ΦC	0.005	0.02
OD of Stub (φD')	1.25, 1.40	
ID (φd)	125um, 126um 127um	
ID Tolerance	+ 0.001/ 0	
Shape of Metal	Customizable Design	
Material	SUS304, SUS303	
Connector	SC, FC, LC, MU / PC & APC	